

CONVERSION KIT FOR XM42 LITE FLAMETHROWER



MANUAL & INSTALL INSTRUCTIONS



ALWAYS FILL CONTAINER ON GROUND
TO REDUCE RISK OF STATIC CHARGE



STEP 1

Make sure you are installing this conversion kit only on the XM42 Lite flamethrower AND you already have/ own the Ultralite Backpack and have all of the parts for the backpack that the Ultralite manual states you need for safe operation of the Ultralite Backpack.

STEP 2



Remove the four screws from the bottom plate and remove the plate.

STEP 3

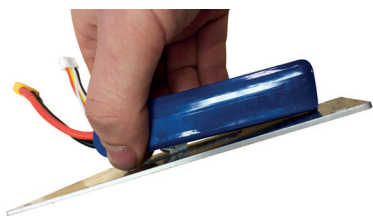

Peel the battery from the original bottom plate carefully. Use a straight edge to help if necessary. Just try to keep from destroying the packaging on the battery.

STEP 4



Grab firmly onto the fuel hose near the bottom of the tank and pull while twisting the hose. This will sometimes take a considerable amount of effort. If you can't get the hose loose by hand it is okay to use flat nosed pliers or channel locks to grab onto the hose with. Just make sure you don't use pliers with sharp ends, this could puncture the hose. Twist the hose with the pliers while pulling until the hose is disconnected from the bottom of the tank.



STEP 5

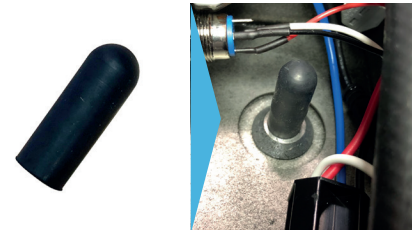

Install the included Chemical-Resistant Round Cap for 1 1/32" OD where you just disconnected the hose from, to prevent your idiot friends from ruining your flamethrower by pouring gas in the top welded-on tank when there's no fuel hose attached to it.



STEP 6



Attach the freshly disconnected end of the hose to the barb on the conversion kit bottom plate.

STEP 7

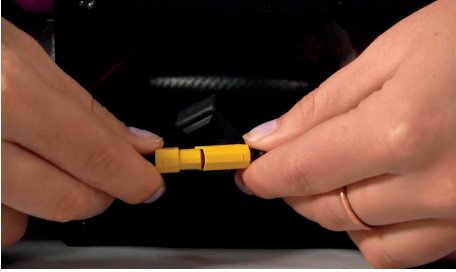

Plug in the battery.

STEP 8



Install the conversion kit bottom plate with the (4) existing bottom plate hardware.

STEP 9

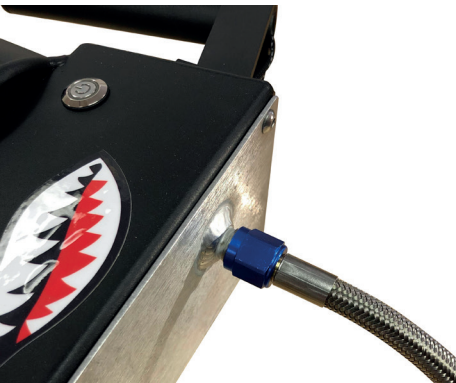

Then, following the instructions in the Ultralite manual, install the ultralite.

Additional Notes

Always inspect all fittings and sight gauge seals/hose for leaks before use.

Keep backpack upright when filled to mitigate chance of leak through check valve on cap. Remove fill cap slowly to vent pressure without causing fuel to spray.

Avoid storing filled with fuel. Keep empty until ready to use. Pressure can build and force fuel to leak from nozzle between uses or during transport. AN fittings are designed to seal without requiring a copper seal, but we prefer all fittings to be as tight as possible to help prevent accidental loosening.

If you require replacement copper flares, contact us. Our website will have them available as well soon.



If you experience any issues with your installation, contact us at support@xm42.com with a brief description of problem and we'll do everything we can to help!